

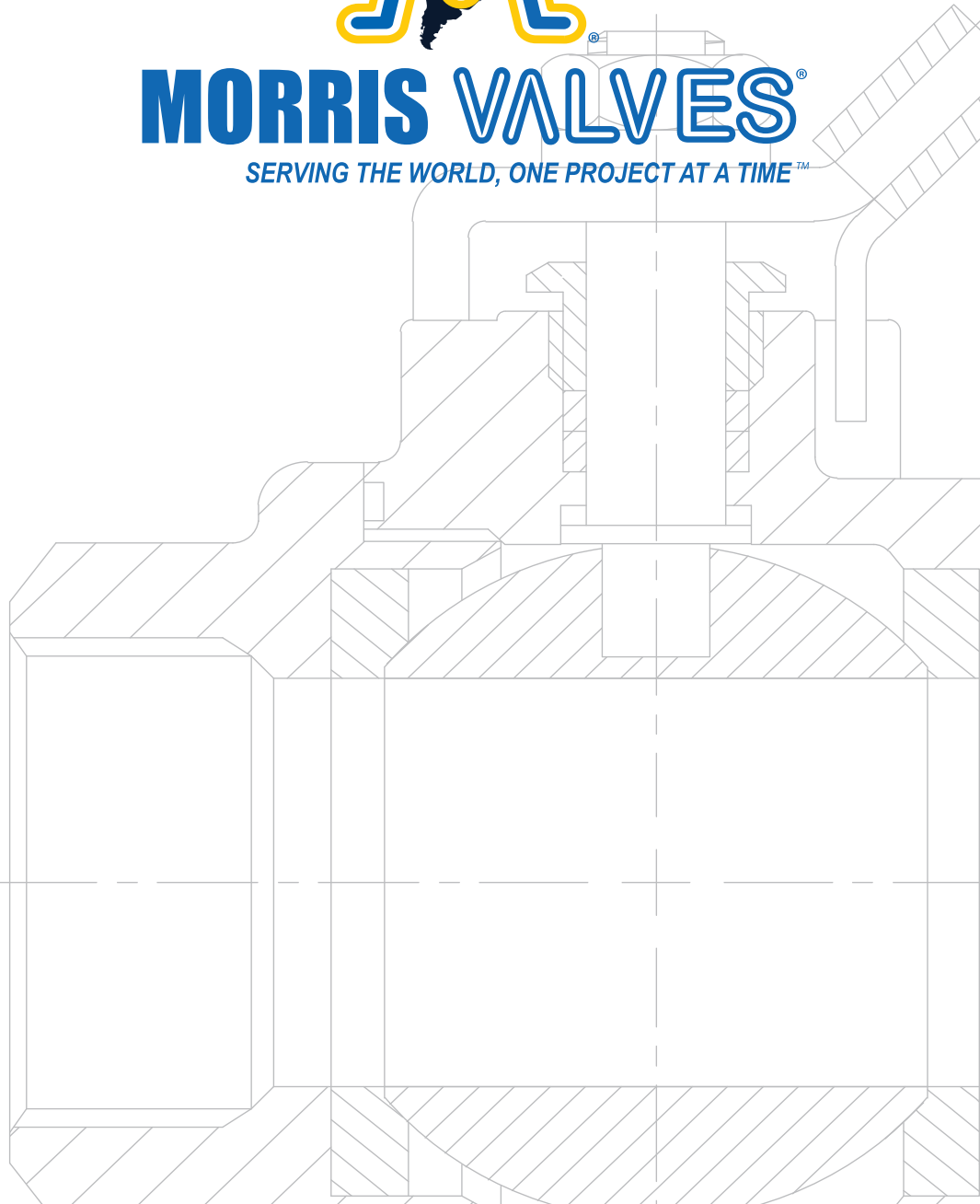

MORRIS VALVES®

SERVING THE WORLD, ONE PROJECT AT A TIME™



API6D, THROUGH CONDUIT GATE VALVE

www.morrisvalve.com



In 1984, our journey into the business of repairing valves and industrial instrumentation began. That journey has led us to represent and service well known American brands and companies. In early 2000, our experience and growing passion for the valve industry encouraged our decision to launch our own brand, Morris Valves. Starting with the highly requested Ball Valves, the brand has been based on the principal of quality and performance to match our customers' needs. Our high standards of production later lead us to incorporate other models such as Gate Valve and Check Valves to our production. These additions were carefully selected to match our Standard of Quality. Our success has been driven by our belief of "Tradition with Quality" in everything we do. Our products are developed with that belief which drives our growth and guides the service we provide to our customers.

Our vision is to be amongst the leading corporations in the supply of goods and services related to valves, their components and industrial equipment in general. We want to conquer new markets in conformity with international standards and remain committed to customer satisfaction, the welfare of our company and the sustainability of our planet.

Mision

Our mission is to use our highly trained, highly focused, and extremely motivated staff to work with manufacturers who value quality and have the vision for new development and product applications to ensure the timely provision of goods and services related to valves, their components and industrial equipment in general. We maintain a rigorous standard of customer satisfaction, which will provide for the welfare of the company, the welfare of the countries we serve, and most importantly the sustainability of the planet.

Contacts

Address: 6803 Theall Rd Building B, Houston, Tx 77066

Telephone: +1 (832) 666-5576

Cel: +1 (786) 779-7469

Email: sales@morrisvalve.com



Vision

"Serving the world, one project at a time"

API6D, SLAB THROUGH CONDUIT GATE VALVE.
 FLANGED END/BUTT WELDING END
 CLASS (300# - 2500#)

TGV TYPE

SPECIFICATIONS:

*Design Standard:

-API6D

-ASME B16.34

*Face to face:

-API 6D; ASME:ASME B16.10

*End Connections:

-FLANGED: ASME B16.5 / ASME B16.47-A

-BUTT WELDING: ASME B16.25

•Test : API 6D / ASME B16.34

•Body Material: ASTM A216 WCB, F304, LCB LF2 F51.

•Actuation: Handwheel, Worm Gear, Electrical, Pneumatic, Hydraulic

FEATURES:

-Trough-Conduit & Full bore body with guide orifice may allow pipeline cleaning. (PIGABLE)

-Highly used in pipelines systems where the main fluids are: Gas, Oil and Petroleum derivatives.

-Bi-directional and totally enclosed body with stem protective cap; can be installed in any of their ends in order to perform properly.

-Stem sealing is combined type design; flexible graphite +304 , plus injection spacer ring.

-Double sealing structure: API6Fa design Metal to Metal primary Seal and PTFE or Nylon inserts on the seat sealing face.

-Double block & Purge. Achieved by its hermetic sealing system that consists in the use of an "O-Ring" and the floating of the seats in an independent way (The seat rings are installed with springs). When the valve is in open or closed position, the PTFE or Nylon inserts are projected against the wedge face, achieving the seal at low pressure. Soft sealing could clean up the dirt on wedge, also.

-Emergency sealing: By means of grease injection through two fittings located at the center of the valve, the grease is distributed all over the surface of the wedge and seats; the result is an emergency sealing system, when the seals (Teflon or Nylon) have suffered some damages, due foreign materials contained in the fluid



MORRIS VALVES
BEYOND THE PIPES, ONE PRODUCT AT A TIME



SIZE:

(2 – 64)"	FULL PORT	Class300
(2 – 48)"	FULL PORT	Class400
(2 – 36)"	FULL PORT	Class900
(2 – 24)"	FULL PORT	Class1500
(2 – 12)"	FULL PORT	Class2500

HOW TO ORDER

TGV - SIZE - RATING - END CONNECTIONS

PARTS	MATERIALS
1 BODY & BONNET	
2 STEM	
3 DISC/WEDGE	
4 SEAT	
5 SEAT INSERT	
6 O - RING	
7 ACTUATOR	

MAIN PARTS AND MATERIALS

(ASTM/ANSI)		
Parts	Water/Oil & Natural Gas	RESIST SSC (Sulfur Stress Crack)
1 DRAIN PLUG	A276 420	A276 304
2 SEALANT- INJECTOR -FITTINGS	A108 - 1025	A108 1025
3 ₁ BODY	A216 WCB	A216 WCB
SEAT	A182 - F6a / STELLITE	A182 F304
4 ₂ SEAT RING	NYLON	PTFE/NYLON
SPRING	INCONEL X - 750	INCONEL X-750
O-RING	VITON	VITON
5 ₃ DISC(WEDGE)	A105 + ENP / A182 F6a / A182 F316	A276 F304
6 STEM	A182 F6a	A182 F304
7 GASKET	FLEXIBLE GRAPHITE + 304	FLEXIBLE GRAPHITE + 304
8 LANTERN RING	A276 410	A276 F304
9 ₁ BONNET	A216 WCB	A216 WCB
10 BONNET BOLT /STUD	A193 Gr 2H	A193 Gr 2H
11 BOLT/STUD NUT	A194 Gr 2H	A194 Gr 2H
12 PACKING	FLEXIBLE GRAPHITE	FLEXIBLE GRAPHITE
13 YOKE	A216 WCB	A216 WCB
14 YOKE BOLT	A193 Gr B7	A193 Gr B7
15 YOKE NUT	A194 Gr 2H	A194 Gr 2H
16 STEM NUT	C95500 NICHEL ALUMINUM BRONZE	C95500 NICHEL ALUMINUM BRONZE
17 BEARING	AISI E51100	AISI E51100
18 GLAND	A108 1025	A108 1025
19 HANDWHEEL	A47	A47
20 STEM PROTECTOR	CARBON STEEL + Zn	A108 1025+#372

Notes.

- 1) A352 LCB is applicable for Cryogenic Services. When there is a strict corrosion rate, for a sulfur corrosion resistant valve, CF8 Material should be selected
- 2) Sealing surface of valve seat, made by deposited welding and hardened layer shall be anti-corrosion treated.
- 3) Surface shall be corrosion-resistant treatment
- 4) Materials selection for normal type valves, is applicable for mediums with total content of H₂S & CO₂ less than 500 mg/m³; Materials selection for sulfur- resistant valves is applicable for mediums with total content of H₂S & CO₂ greater than 500mg/m³ and meeting specifications MR0175
- 5) If not specified otherwise, above-mentioned configurations of flat gate valves, are suitable for conventional water, Oil & natural Gas, etc.

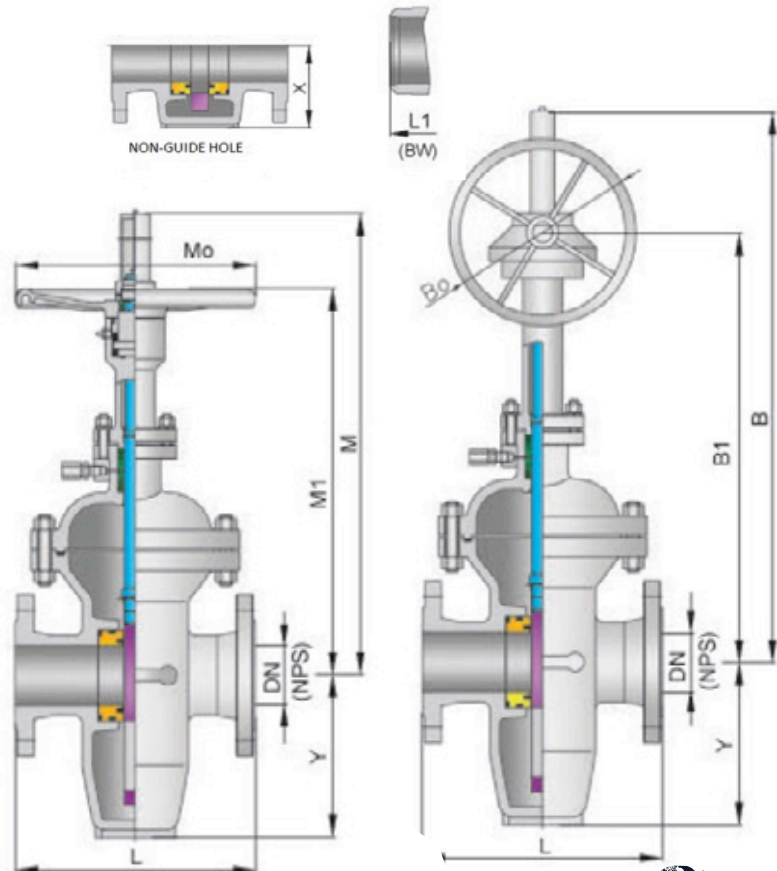
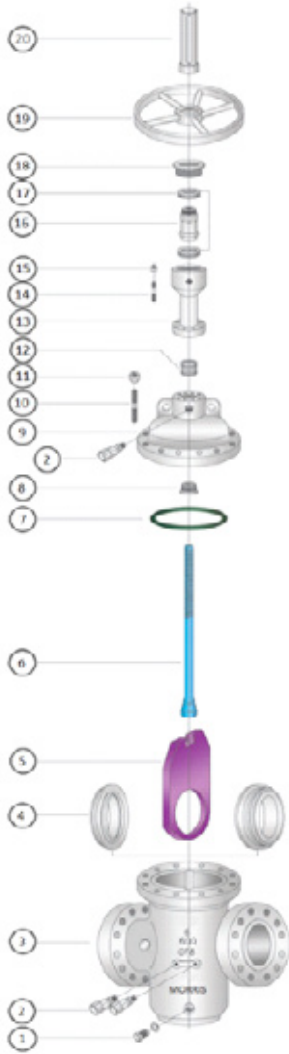

MORRIS VALVES
BEHIND THE WORLD, ONE PROJECT AT A TIME



A Tradition of Quality

*Our passion is to develop
solutions for difficult situations in
Industrial Applications, no matter
how large or small the project.*

“Serving the world, one project at a time”

